



WiFi Multi-Function Protector

Multiple protection & automatic reclosing



KNS5-VAW/IP+N Adjustable V/A Protector



● Application

The adjustable voltage, current and leakage detection protection device, with a kilowatt-hour meter, is an intelligent protector that integrates overvoltage protector, undervoltage protector, overcurrent protector and leakage detection. In the event of an overvoltage fault, undervoltage fault, or overcurrent fault, the product can immediately cut off the power supply to avoid damage to electrical equipment. The overvoltage, undervoltage, overcurrent and leakage detection switches of the product can be set by the user and adjusted according to local actual conditions.

● Product Features

1. In the case of overvoltage fault, undervoltage fault, overcurrent fault in the single-phase line, the product can disconnect the line power supply and automatically restore the line connection after a delay time after the line voltage or current returns to normal.
2. In the case of instantaneous overvoltage in the line, the product can protect the equipment from misoperation.
3. If the leakage detection switch is turned on, when the line is affected by unstable voltage or sudden power failure and power on due to loose connection and other faults, the product will disconnect the line after three seconds.
4. When the line fault voltage reaches the peak, the product itself will not be damaged.
5. The protector can display kilowatt-hours, KW and power factor.

● Over current protection status

When over-current, the protector automatically disconnects, the over-current alarm indicator on, and the screen shows the over-current value.

→

When the current turns normal, the over-current alarm indicator off, and the protector resets automatically within the set recovery time.

When continuous over current faults times reaches the set value, the protector will not reset automatically, it needs to be reset manually by pressing key.

● Wiring diagram

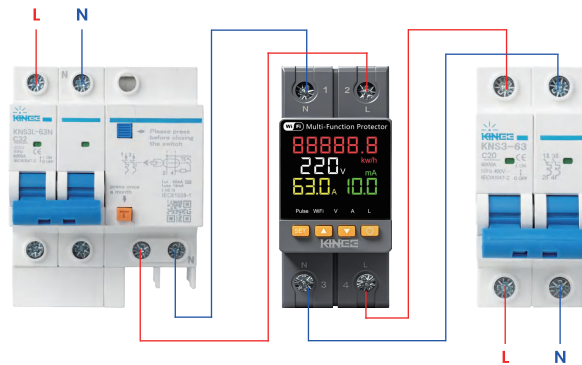

● Leakage detection status

When the leakage detection switch is closed, if leakage occurs, the protector will automatically disconnect, the leakage alarm indicator will light up.

→

After the leakage protection, you need to press the manual switch to restart to return to normal.

Leakage detection switch, Default OFF

● Installation dimension



● Main technical parameter

Function	Technical Parameter	Function	Technical Parameter
Input voltage	AC 95-300V	Power-on delay time	1-999s default 5s
Over-voltage protection value	130-300V default 270V	Over-voltage recovery value	125-295V default 265V
Under-voltage protection value	95-210V default 170V	Under-voltage recovery value	100-215V default 175V
Over-current protection value	63A: 1-63A default 40A	Continuous over-current times	1-20 times default OFF
Leakage protection value	10-100mA default OFF	Voltage protection action time	0-30s times default 1s
Recovery delay time	1-999s default 30s	Current protection action time	0-30s times default 1s
Mechanical life	≥100000 cycles	Power consumption	≤2W
Password Setting	000-999 default 118	Size	85*37*69mm

● Panel indicator lamps and keys instructions

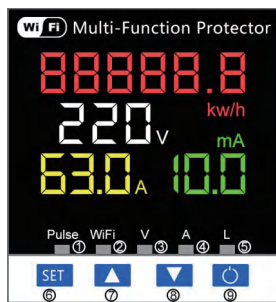

- ① Kilo-watt hour meter pulse indicator
- ② WiFi indicator
- ③ Over/under voltage alarm indicator
- ④ Over-current alarm indicator
- ⑤ Leakage alarm indicator
- ⑥ Set: Menu setting key
- ⑦ Adjustment key +

Press for 5 seconds and the battery power will be cleared

- ⑧ Adjustment key -

Press and hold for 5 seconds, the WiFi indicator light flashes and the device enters pairing mode.

- ⑨ Manual switch

Press the power button to OFF, then press and hold the power button for 5-10 seconds until it restarts to restore to factory settings.

● Screen display description

● Over voltage protection status

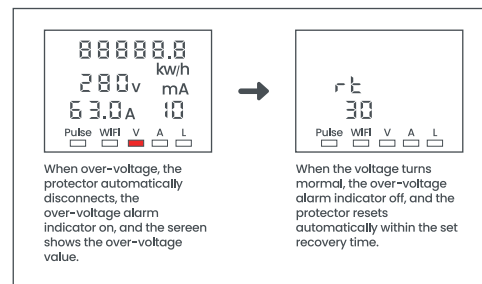

● Under voltage protection status

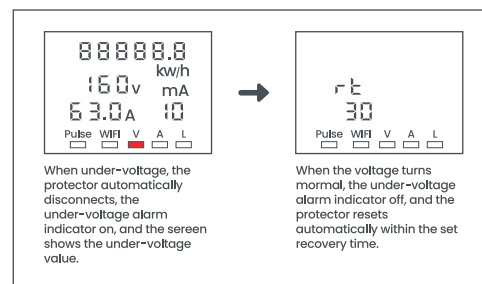

● Setup menu

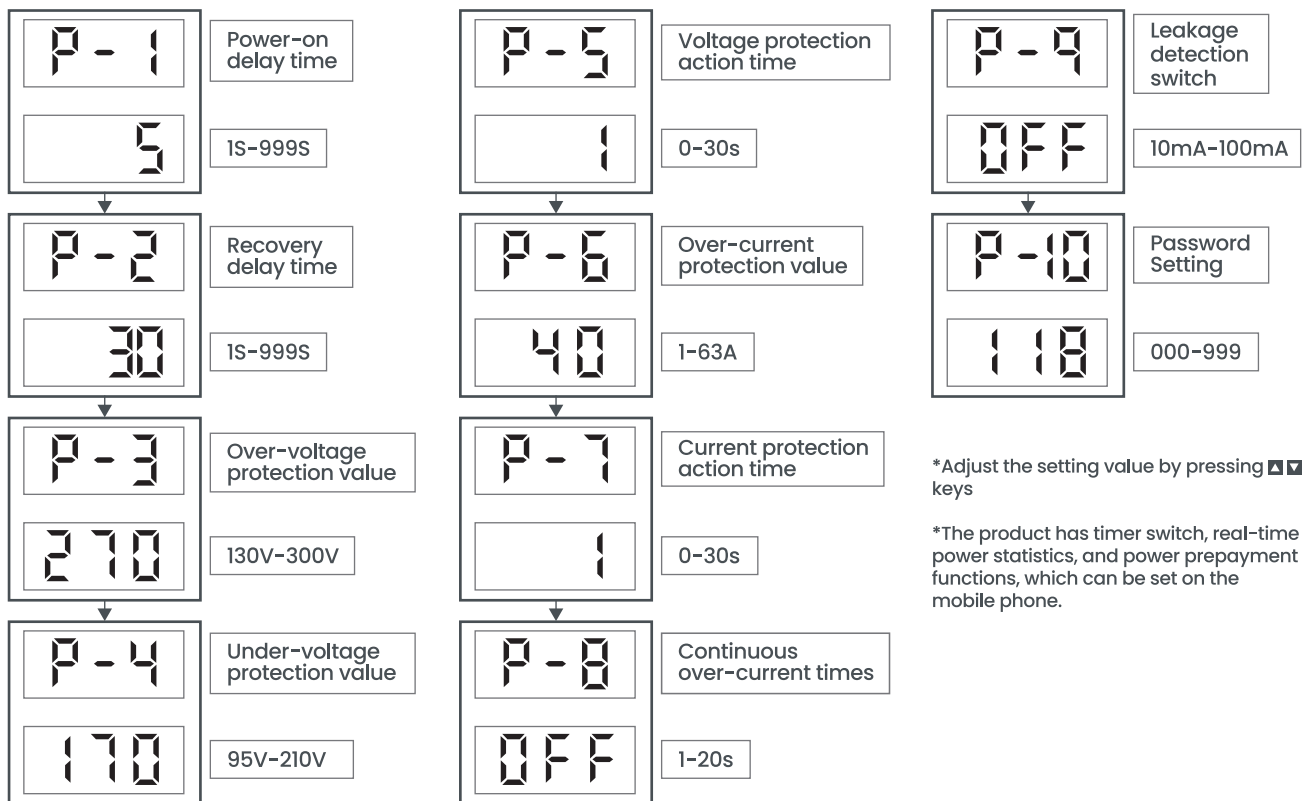

● Protector networking steps

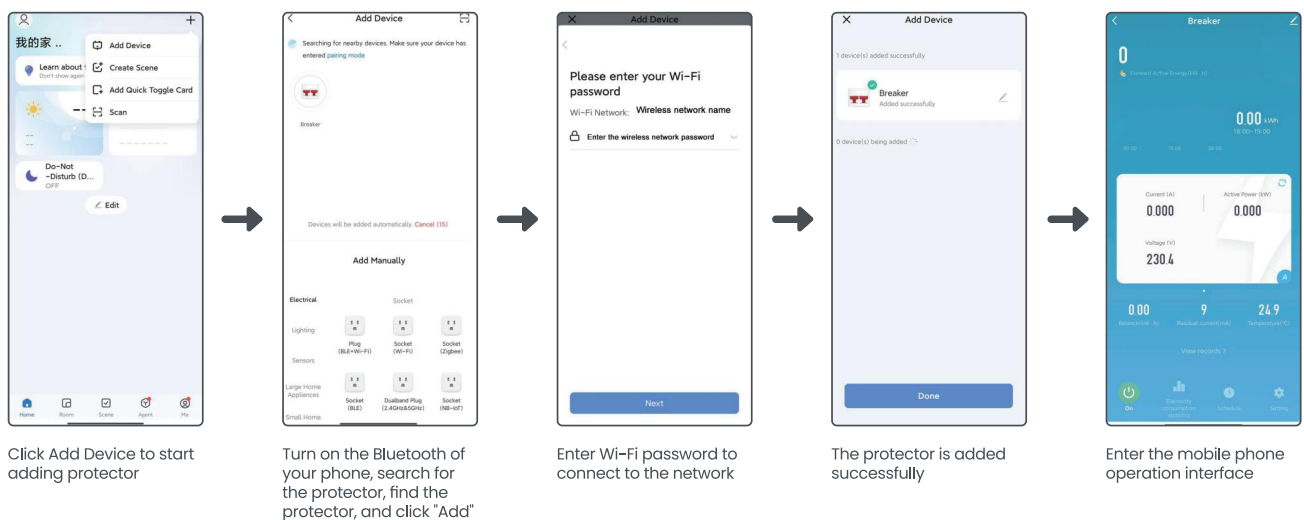

▲ Note:

1. This product is only used for leakage detection and provides only a reference for leakage values. It cannot replace the leakage protector.
2. Leakage detection switch, closed by default, if you need the detection function, you need to turn it on manually.
3. The WiFi indicator light flashes and is in network configuration state.
4. The WiFi indicator light is always on, indicating that the mobile device has been connected.
5. To ensure service life, it is recommended to set the current parameter to 70%.



Scan the QR code or search for "smart life App" in the App Store and download it



WhatsApp

WENZHOU KINEE ELECTRICAL CO.,LTD

Room 101, Building 31, Wenzhou Cultural and Creative Technology Industrial Park,
No. 706 Yanyun Road, Kumpeng Street, Wenzhou Marine Economic Development
Demonstration Zone, Wenzhou City, Zhejiang Province



+86 18066273999



www.kinee.net



sandyma@kinee.net.cn